

# J&O<sup>®</sup>

J&O FLUID CONTROL CO., LIMITED

## Pipe Holder

# J&O<sup>®</sup>

J&O FLUID CONTROL CO., LIMITED

Address: Binhai ETDZ, 5 Road, Longwan, Wenzhou, China. 325000

Tel: +86 577 8663 2750

Fax: +86 577 8663 2850

Mob./WhatsApp: +86 186 5778 5727

Site: [www.sanitary-valves.com](http://www.sanitary-valves.com)

Email: [Info@jo-pv.com](mailto:Info@jo-pv.com)

With more than 15 years of market experiences, we have become the leading supplier service for pharmaceutical, chemical, food, Beverage and Lithium battery companies



Site Code



WhatsApp Code

J&O BRAND, RELIABLE QUALITY FOR YOU

CE&ISO 9001:2015 CERTIFIED ACQUIRED

15 YEARS FLUID SOLUTION EXPERIENCES

EXPORTING TO OVER 40 COUNTRIES

EXCELLENT VALUE-ADDED SERVICE.

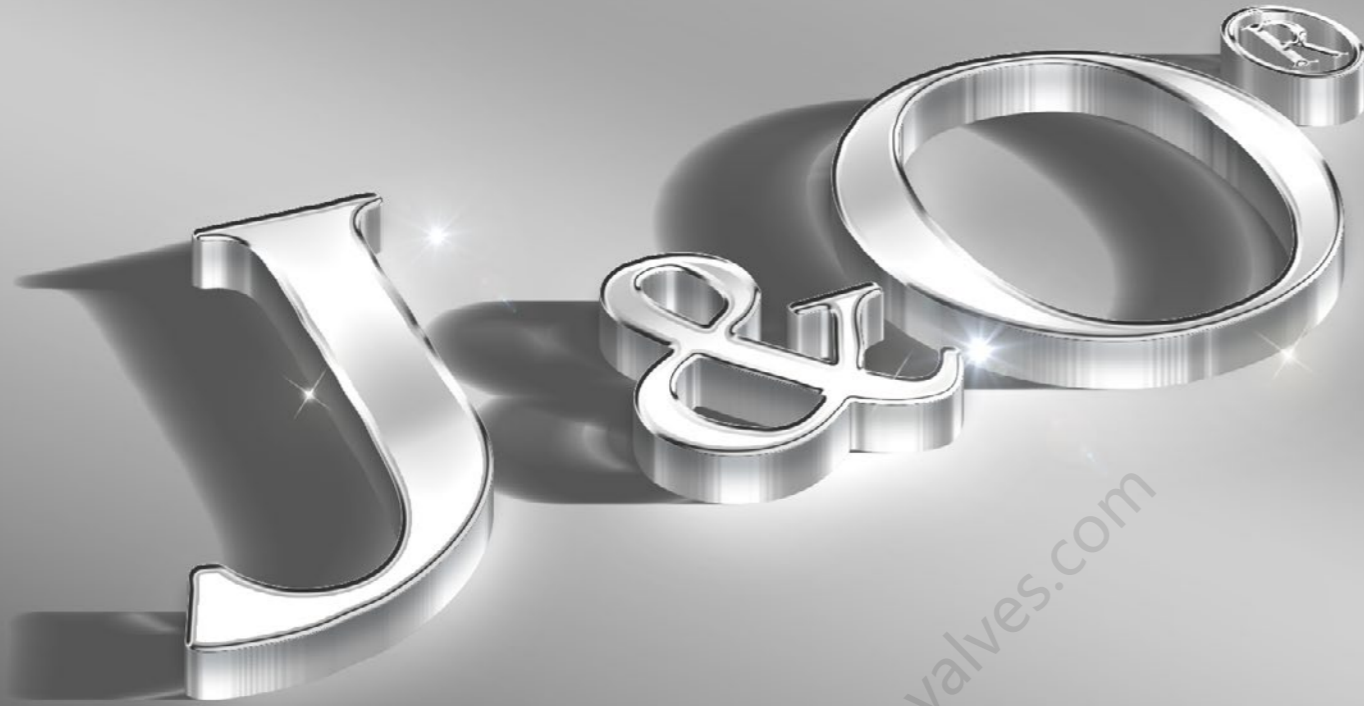

We focus on Details  
We Make Different  
J&O Brand, that can be trust.

## J&O PROFILE

J&O Fluid Control Co., Limited established in 2008, a leading Manufacturer and Supplier of high quality hygienic stainless steel flow control equipments.

J&O services the Food, Dairy, Beverage, Cosmetic, Pharmaceutical, Biological engineering, Lithium battery, Semiconductor, Water treatment, Petroleum and Chemical industries.

J&O product series consists of sanitary stainless steel Valves & Fittings:

- >>Sanitary Stainless Steel Pumps
- >>Sanitary Stainless Steel Valves
- >>Stainless Steel Tank Accessories
- >>Stainless Steel Pipe Fittings
- >>Stainless Steel Flanges
- >>Stainless Steel Double Ferrule Tube Fittings
- >>Hydraulic Pneumatic Quick Coupling
- >>Carbon Steel Pipe Fittings
- >>Customized Valve and Fittings

Through the years, "Perfection" has been the only goal we pursue. In order to satisfy customers, with continuous efforts, we are working towards perfection through a Quality Assurance System. With persistence and effort, we have become one of the leading enterprises of sanitary valves and pipe fittings in China.

Our organization is dedicated to provide our customers with best service of every aspect. We strongly believe, that the friendship and trust given by our customers, is the great treasure we have.

**J&O<sup>®</sup>**  
J&O FLUID CONTROL CO., LIMITED

# Certificate



# Plant & Producing



# Testing Machine

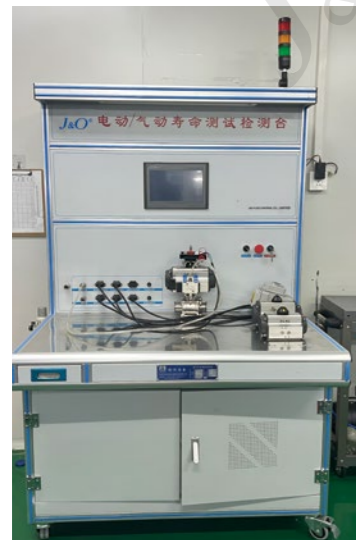

Actuator Testing



Helium Leak Detector



Pressure Test for Large Valve

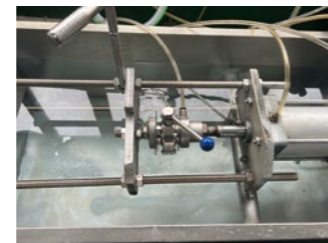

Pressure Test for Small Valve

## Pipe Holder



Pipeline support refers to a structural component used for supporting overhead pipelines laid above ground. It is divided into fixed brackets, sliding brackets, guide brackets, rolling brackets, etc. Pipe supports are used wherever pipelines are laid, also known as pipe supports, pipe sections, etc. As a support structure for pipelines, the pipe rack is divided into fixed and movable types based on the operational performance and layout requirements of the pipeline. The place where fixed points are set becomes a fixed support, and this type of pipeline cannot have relative displacement with the pipeline support. Moreover, the deformation of the fixed pipeline support after being subjected to force should be small compared to the deformation value of the pipeline compensator, because the pipeline support needs to have sufficient stiffness. The place where the intermediate support is set adopts a movable pipe rack, and relative displacement is allowed between the pipeline and the pipe rack, without constraining the thermal deformation of the pipeline.

1. Divided into three levels according to load: extra light level (Q), medium level, and extra heavy level (Z). In each load level, there are four types of structures: axial sliding, bidirectional sliding, guided sliding, and double guided sliding.
2. According to the material of the support, it can be divided into steel structure, reinforced concrete structure, brick and wood structure, etc.
3. It can be divided into movable supports (supports that allow for displacement of the pipeline on the support) and fixed supports (supports fixed to the pipeline) according to their purpose.

# Pipe Holder

Our Core Values: Team, Details, Altruism, Innovation and Embrace Change.



www.sanitary-valves.com



www.sanitary-valves.com

Pipe Holder

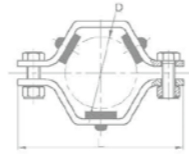

JOPH-TH4

Size	D	L
1"	25.4	87
1 1/2"	38.1	101.6
2"	50.8	114.3
2 1/2"	63.5	120.6
3"	76.2	139.7
4"	101.6	171.4

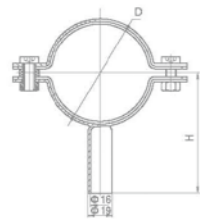

JOPH-TH007

Size	D	H
1/2"	12.7	58.4
3/4"	19.1	62.5
1"	25.4	65.7
1 1/2"	38.1	72
2"	50.8	78.4
2 1/2"	63.5	84.8
3"	76.2	91
4"	101.6	103.8
5"	129	17.5
6"	154	130
8"	204	155
10"	254	180
12"	304	205

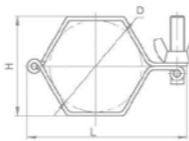

JOPH-TH2

Size	D	L	H
1"	25.4	87	28
1 1/2"	38.1	101.6	40
2"	50.8	114.3	52
2 1/2"	63.5	120.6	66
3"	76.2	139.7	77
4"	101.6	171.4	104

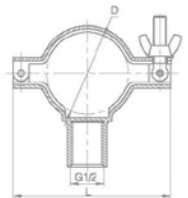

JOPH-TH1M

Size	D	L
1"	25.4	61
1 1/2"	38.1	76
2"	50.8	90
2 1/2"	63.5	106
3"	76.2	120
4"	101.6	146

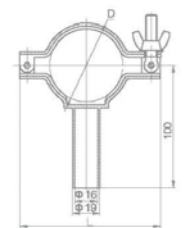

JOPH-TH1H

Size	D	L
1"	25.4	61
1 1/2"	38.1	76
2"	50.8	90
2 1/2"	63.5	106
3"	76.2	120
4"	101.6	146

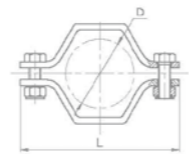

JOPH-TH4-1

Size	D	L
21.3	21.3	66
26.9	26.9	74
33.7	33.7	82
42.4	42.4	93
48.3	48.3	101
60.3	60.3	114
88.9	88.9	149
114.3	114.3	177

Pipe Holder

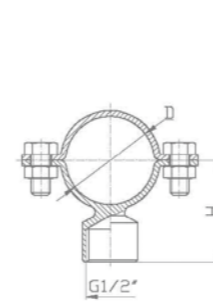

Size 1/2"-4"

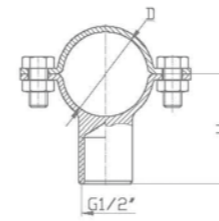

Size 5"-12"

JOPH-TH007-33N

Size	D	H
1/2"	12.7	35.85
3/4"	19.	39
1/2"NB	21.3	40.15
1"	25.4	42.2
3/4"NB	26.7	42.85
1 1/4"	32	45.5
1"NB	33.4	46.2
1 1/2"	38.1	48.55
1 1/4" NB	42.2	50.6
1 1/2" NB	48.3	53.65
2"	50.8	55
2"NB	60.3	59.65
2 1/2"	63.5	62
2 1/2" NB	73	66.5
3"	76.2	68
3"NB	89	74.5
4"	102	82
4"NB	114	88
5"	129	101.5
6"	54	114
6"NB	168	122
8"	204	139
10"	254	164
12"	304.8	189

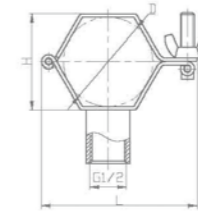

JOPH-TH3-33N

Size	D	L	H
1"	25.4	61	28
1 1/2"	38.1	76	40
2"	50.8	90	52
2 1/2"	63.5	106	66
3"	76.2	120	77
4"	101.6	146	104

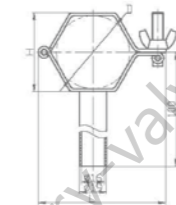

JOPH-TH3

Size	D	L	H
1"	25.4	61	28
1 1/2"	38.1	76	40
2"	50.8	90	52
2 1/2"	63.5	106	66
3"	76.2	120	77
4"	101.6	146	104

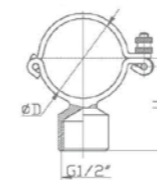

JOPH-TH3R-33N

Size	D	H
1/2"	12.7	35.85
3/4"	19.	39
1/2"NB	21.3	40.15
1"	25.4	42.2
3/4"NB	26.7	42.85
1 1/4"	32	45.5
1"NB	33.4	46.2
1 1/2"	38.1	48.55
1 1/4" NB	42.2	50.6
1 1/2" NB	48.3	53.65
2"	50.8	55
2"NB	60.3	59.65
2 1/2"	63.5	62
2 1/2" NB	73	66.5
3"	76.2	68
3"NB	89	74.5
4"	102	82
4"NB	114	88



## Pipe Holder

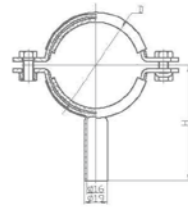

**JOPH-TH6**

Size	D	H
1/2"	12.7	90
3/4"	19.1	90
1"	25.4	90
1 1/2"	38.1	90
2"	50.8	90
2 1/2"	63.5	90
3"	76.2	90
4"	101.6	90
5"	129	117.5
6"	154	130
8"	204	155
10"	254	180
12"	304	205

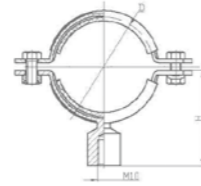

**JOPH-TH6-33N**

Size	D	H
1/2"	12.7	40.4
3/4"	19.1	44.5
1"	25.4	47.7
1 1/2"	38.1	54
2"	50.8	60.4
2 1/2"	63.5	66.8
3"	76.2	73
4"	101.6	85.8
5"	129	99.5
6"	154	94
8"	204	137
10"	254	162
12"	304	187

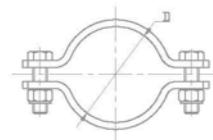

**JOPH-TH5-1**

Size	D	N
DN10	13	20
DN15	19	20
DN20	23	20
DN25	29	20
DN32	35	20
DN40	41	20
DN50	53	20
DN65	70	20
DN80	85	25
DN100	104	25
DN125	129	30
DN150	154	40
DN200	204	50
DN250	254	60

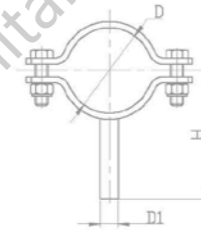

**JOPH-TH5**

Size	D	D1	H	N
DN10	13	8	64	20
DN15	19	8	67	20
DN20	23	8	69	20
DN25	29	10	72	20
DN32	35	10	75	20
DN40	41	10	78	20
DN50	53	12	84	20
DN65	70	12	93	20
DN80	85	12	100	25
DN100	104	12	110	25
DN125	129	16	140	30
DN150	154	16	180	40
DN200	204	20	240	50
DN250	254	24	280	60

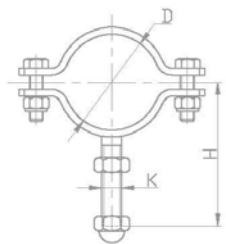

**JOPH-TH5-2BN**

Size	D	K	H	N
DN10	13	M8	74	20
DN15	19	M8	77	20
DN20	23	M8	79	20
DN25	29	M10	102	20
DN32	35	M10	105	20
DN40	41	M10	108	20
DN50	53	M12	114	20
DN65	70	M12	123	20
DN80	84	M12	130.5	25
DN100	104	M12	140	25
DN125	129	M16	168.5	30
DN150	154	M16	202	40
DN200	204	M20	255	50
DN250	254	M22	295	60

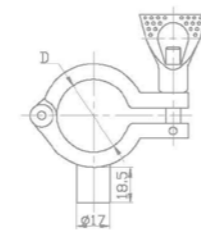

**JOPH-3AHD**

Size	D
1"	25.4
1 1/4"	31.8
1 1/2"	38.1
2"	50.8
2 1/2"	63.5
3"	76.2
3 1/2"	89
4"	101.6

## Pipe Holder

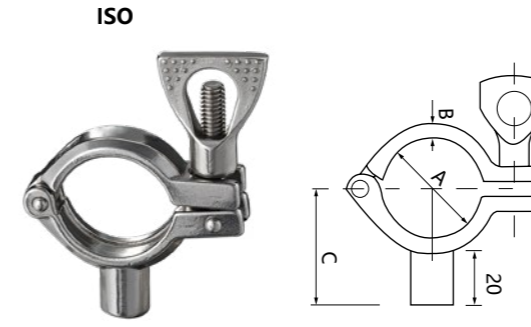

**JOPH-ISO-11**

- Material: AISI 304
- Flux domination of pipeline:  $\Phi 25-305$  & 1"-12"

Size	A	B
1/2"	12.7	58.4
3/4"	19.1	62.5
1"	25.4	65.7
1 1/2"	38.1	72
2"	50.8	78.4
2 1/2"	63.5	84.8
3"	76.2	91
4"	101.6	103.8
5"	129	117.4
6"	154	130
8"	204	155
10"	254	180
12"	304	205

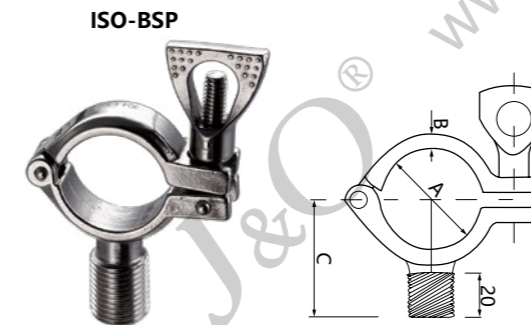

**JOPH-ISO-33W**

- Material: AISI 304
- Flux domination of pipeline:  $\Phi 25-152$  & 1"-6"

Size	A	B	C
1/2"	12.70	7.50	38.00
3/4"	19.05	7.50	38.00
1"	25.40	7.50	38.00
1 1/2"	38.10	7.50	45.00
2"	50.80	7.50	50.00
2 1/2"	63.50	7.50	60.00
3"	76.20	9.00	68.00
4"	101.60	9.00	78.00
5"	127	9.00	78.00
6"	152.40	9.00	82.00

Pipe Holder

ISO-BSP



JOPH-ISO-33N

- Material: AISI 304
- Flux domination of pipeline:  $\Phi 25-152$  & 1"-6"

Size	A	B	C
1/2"	12.70	7.50	38.00
3/4"	19.05	7.50	38.00
1"	25.40	7.50	38.00
1 1/2"	38.10	7.50	45.00
2"	50.80	7.50	50.00
2 1/2"	63.50	7.50	60.00
3"	76.20	9.00	68.00
4"	101.60	9.00	78.00
5"	127	9.00	78.00
6"	152.40	9.00	82.00

3A-BSP

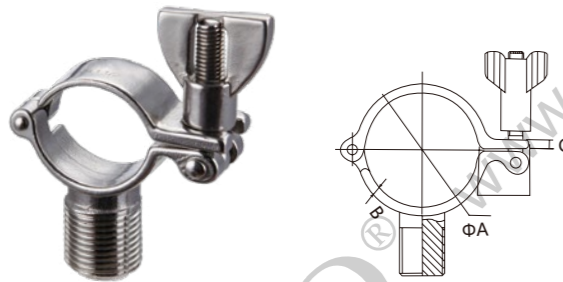

JOPH-3A-33W

- Material: AISI 304
- Flux domination of pipeline:  $\Phi 25-305$  & 1"-12"

Size	A	B	C
1"	25.4	3	5mm
1.5"	38.1	3	5mm
2"	50.8	4	6mm
2.5"	63.5	4	6mm
3"	76.2	5	7mm
4"	101.6	5	7mm
5"	127	5	7mm
6"	152.4	5	7mm
8"	203.2	6.5	7mm
10"	254	6.5	7mm
12"	304.8	6.5	7mm

A large grid area for writing a memorandum, consisting of a 20x20 grid of squares. A faint watermark 'www.sanitary-valves.com' is visible across the grid.